

Tornado [Mar. 6, 2013]/Year 2000-Current: Schematics, Accessories, Brochures, Replacement & Optional Items/Automatic Scrubbers/20" & 24" EZ Floorkeepers/99105A 20" EZ BD Floorkeeper (w/ 2-12 V Batteries) - Series F/Control/Instrument System Assembly

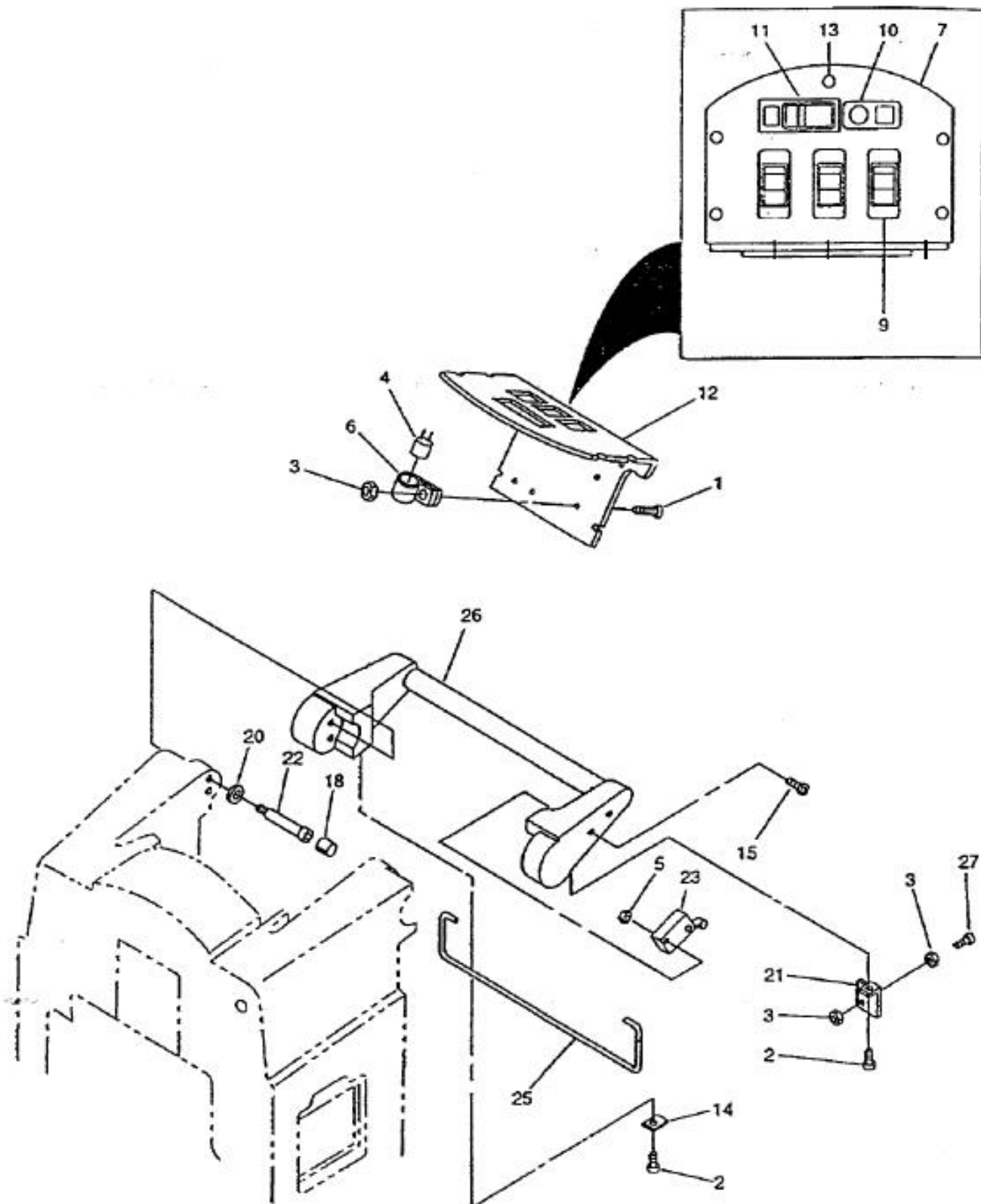

No.	Part No.	Qty.	Description
1	16075	2	SCREW PHIL. PAN HD MACH
2	02071	2	SCREW TCT (T) R.H.
3	02956	3	NUT HEX.LOCK(KEPS)
4	14827	1	FLASHER RELAY
5	15560	2	NUT HEX.LOCK(KEPS)
6	15913	1	CLAMP 1.13 EZ
7	33894	1	EZ CONTROL PANEL
9	33895	3	Switch
10	18218	1	INDICATOR LIGHT 28V(RE D)
11	18221	1	GAUGE BATTERY CONDITION
12	31028	1	PANEL, BACK ACCESS
	33918		TANK PANEL EZ (31028)
13	18253	9	SCREW T.F.PLT60 PAN HEAD
14	18266	1	PLATE SPEED CNTRL. BAR R
15	18323	2	SCREW PHIL. PAN HD MACH
18	18593	1	CAP SCREW THREAD BLACK VINYL
20	14142	4	Washer
	X8235		Washer 1/4" Flat Zinc
21	18675	1	BRACKET DEAD MAN HANDLE
22	08079	4	SCREW SOCKET HD SHOULDER
23	15542	1	SWITCH LEAF S.P.D.T.
25	18895	1	WELDMENT BRUSH ACTUATION
26	18896	1	HANDLE CONTROL(EZ BD)
27	18897	1	SCREW PHIL. FLAT HD MACH